

Coastal



Dogwood



French Contemporary

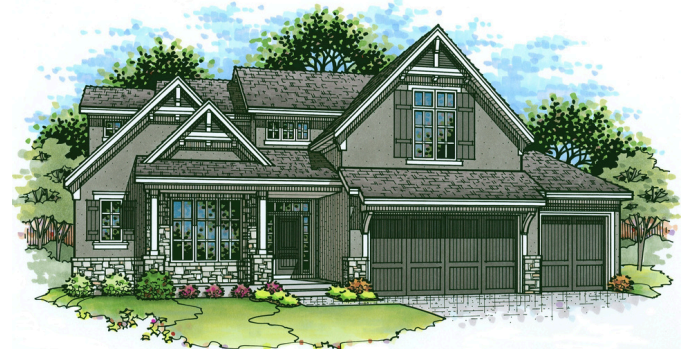

Magnolia

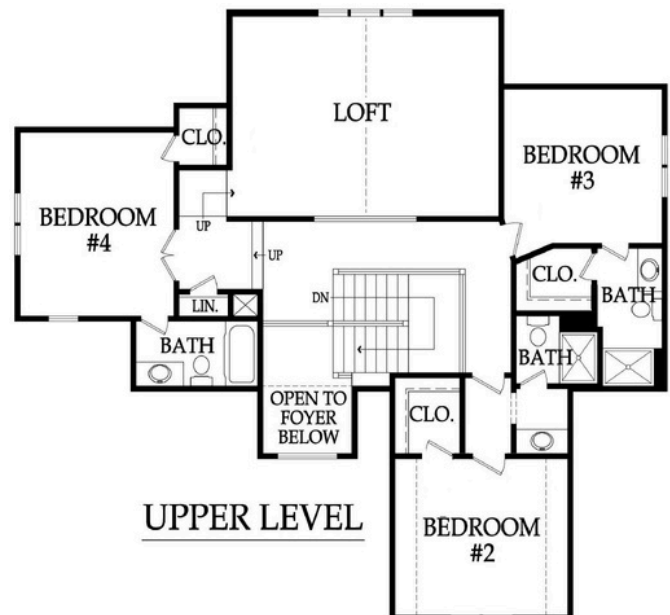

Renderings are for illustration purposes only and may show upgrades. The materials used on the renderings are only examples of what can be installed. Consult Builder for details.

Appliances

Stainless Steel Appliance Package: Dishwasher, Gas Cooktop, Wall Oven,
Hood Insert (Vented to Exterior) & Microwave (GE Profile)
Ice Maker Water Line at Refrigerator Opening

Plumbing and Fixtures

50 Gallon Water Heater
Lower-Level 3/4 Bath and Bar Stub
Chrome Plumbing Package Throughout the Home
Drop-In Jetted Tub & Frameless Shower Door in Primary Bath

Cabinets and Countertops

*Choice of Birch, Poplar or Paint Grade Cabinets
Kitchen Cabinets include Hidden Hinges, Full Extension Drawer Glides,
Adjustable Shelving, Pull-Out Trash Can & Spice Rack
Walk-In Pantry with 5 Shelves
Level 1 Granite/Quartz Tops in Kitchen with Undermount Stainless Steel Sink
Level 1, 2cm Quartz Tops with Integrated Sink in all Bathrooms
Base + Upper Cabinet per Plan at Laundry with Level 1, 2cm Quartz

*Cabinet grade is dependent on paint selections or Builder may substitute wood species per final Decor Sheet

Electrical and Low Voltage

200 AMP Service Panel with Breakers
LED Light Bulbs in all Can Lights
3 Exterior Outlets (Minimum)
Wired & Switched for Ceiling Fan in Hearth Rooms & All Bedrooms
Prewire for Security System (1 Drop by Garage Door)
Cat6 Wiring with Cable/Data Locations in all BR's, Hearth Room, & Study per Plan
Under Cabinet Wiring in Kitchen per Plan

Energy Efficient Features

96% Lennox Furnace with Humidifier and 14 SEER A/C
2 HVAC Systems
ZIP System Wall Sheathing
Independently Rated RESNET HERS Index Home
R-15 Blown-In Blanket Insulation
Energy Star Compliant Foam and Caulk Package
Air Sealant in the Attic
Energy Efficient Low-E/Argon Gas Windows (choice of White or Sandstone)

Exterior

*9' Foundation Walls with Concrete Egress Window Well
Limited Lifetime Warranty Roof
Front: Stucco, Stone or Siding per Elevation with LP Smart Trim
Sides/Rear: Double Wall Construction w/ Zip Wall & Tape, or comparable product
5" Aluminum Gutters (Choice of Color)
Insulated Garage Door w/ 2 Openers, 1 Keypad and Smart Capabilities
6'-8" Fiberglass Front Door w/Clear Glass Side Lites per Plan
Covered Patio, Optional Covered Deck w/Composite Flooring
2 Exterior Hose Bibs, Mounted AC Unit to Foundation

*Height of wall before basement is poured

Fireplace, Trim and Mirrors

Direct Vent Fireplace with Tile Surround
Built-in Boot Bench per Plan
Curbed Stairs with Iron Spindles
Oil Rubbed Bronze or Brushed Nickel Doorknobs & Hinges
Trim Wrapped Mirrors in all Baths
Large Baseboard and Casing throughout Main Floor
Choice of 6 Interior Door Styles
Crown Molding per Plan, Box Vault in Primary Bedroom
Expansive Ceiling in Great Room, Box Vault in Breakfast Area

Flooring and Tile

Pre-Finished Hardwood Floors included in Entry, Great Room, Kitchen, Pantry,
Breakfast Area, Mud Room and Main Floor Powder Bath per Plan
Ceramic Tile Floors in Laundry, Primary Bath and Secondary Baths
Ceramic Tile on all Shower Walls, Tub Walls and Kitchen Backsplash
Ceramic Tile in Primary Shower Pan

Paint

Interior: 3 Wall Colors (Flat/Latex), 1 Enamel, 1 Stain
(in addition to stain on hardwoods)
White or Light colors and Ultra Dark colors may incur an additional charge.

Exterior: 1 Body Color, 1 Trim Color, 1 Accent Color
White or Light colors may incur an additional charge.

Site Work

Site Cost Coverage-up to \$10,000 (See Addendum)
Landscaping Allowance of \$3,000 unless specified otherwise in CUP
Fully Sodded Lot with Bluegrass Sod up to 11,000 SF
Sump Pump

Standard Allowance

Appliances: \$3,645
Lighting: \$4,000
Tile: Standard (See Addendum)
Carpet: \$1.78 per Square Foot
Stair Carpet: \$3.90 per Square Foot
Commission: Home Site up to \$120,000

Experience the Bickimer Difference

Professional Expert Guidance throughout the Sales, Building & Warranty Process
On-site Meetings throughout the Build
Full Access to Professional Decorator and Design Center
Passive Radon Stub
HVAC Ductwork Professionally Cleaned at Closing
Plumbing Drain Lines Professionally Inspected at Closing
In-House Warranty Program with Unmatched Customer Service